

62M Mop Service Basin – 24" x 24" x 8 1/4"





Engineered and built to provide years of service, Mustee's 62M Mop Service Basin includes all the features most wanted by maintenance and housekeeping professionals. Mustee mop basins are also being installed in homes for a wide variety of cleaning tasks. A complete range of accessories are also available to customize your Model 62M to best meet specific application needs.



Features:

- High impact resistant, one piece molded DURASTONE® structural fiberglass
- Generous 8 1/4" high side walls to contain splashes
- Removable strainer
- Integral molded-in drain with seal for installing to 3" ABS, PVC. (Sch. 80) or cast iron
- Available drain seals for connecting 2" pipe or 3" no-hub soil pipe
- Convenient anchor brackets for securing to wall
- A complete range of mop basin accessories is available to customize your application, see reverse side for details

Code Listed:

- IAPMO® Listed 
- Warnock Hersey Listed 
- CSA Test Standards: Mop Basin – #B45.0 
- American National Standards Institute (ANSI) — Specification Z 124.6 
- American Society of Testing and Material (ASTM) — D 635, E 84 and E 162
- CAN/ULC S102-07 Burn and Smoke Test

Specifications

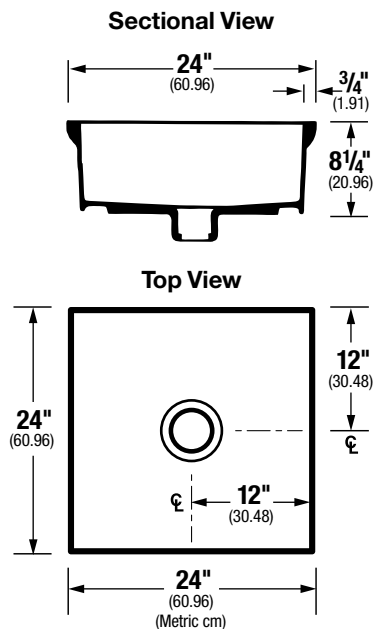

Model	Color	I.P.S.	Size
62M	White	3	24" wide x 24" deep

Sub-Floor Rough-in — for slab
leave 2 1/4" min. depth

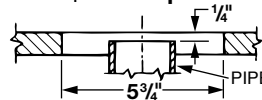

Anchoring Brackets Provided — for securing mop basin to wall

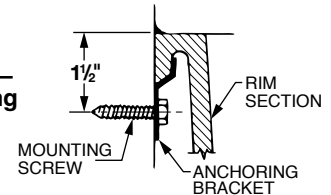

General: Furnish and install as shown on plans, Mop Service Basin model 62M, as manufactured by E.L. Mustee & Sons, Inc. Unit to be one-piece, molded fiberglass made with matched metal molds using extreme heat and pressure. Height shall be 8 1/4" with not less than 3/4" wide shoulder. Size 24" x 24". Drain shall be integrally molded, complete with drain seal for installation of 3" ABS, PVC (Sch. #80) and iron pipe. Removable stainless steel strainer. Performance tested to meet or exceed ANSI Specifications Z 124.6. Weight 45 lbs. Install in compliance with local codes.

MUSTEE Mop Basins are ideal for...

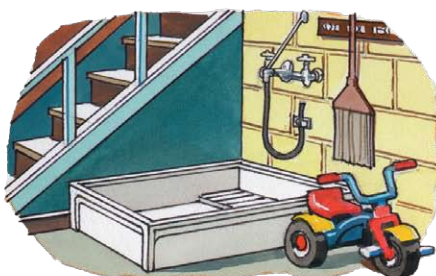

Washing Muddy Toys



Pet Washing



Garden Tool Cleanup

To reorder, specify ADV-357

Notice: Our continuous commitment to product improvement may result in changes to product specifications without notice. Patented and patents pending. ADI/5-10/NM. Made and Printed in U.S.A.

Mop Service Basin Accessories (Order Separately)

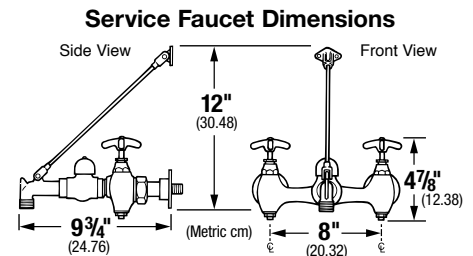
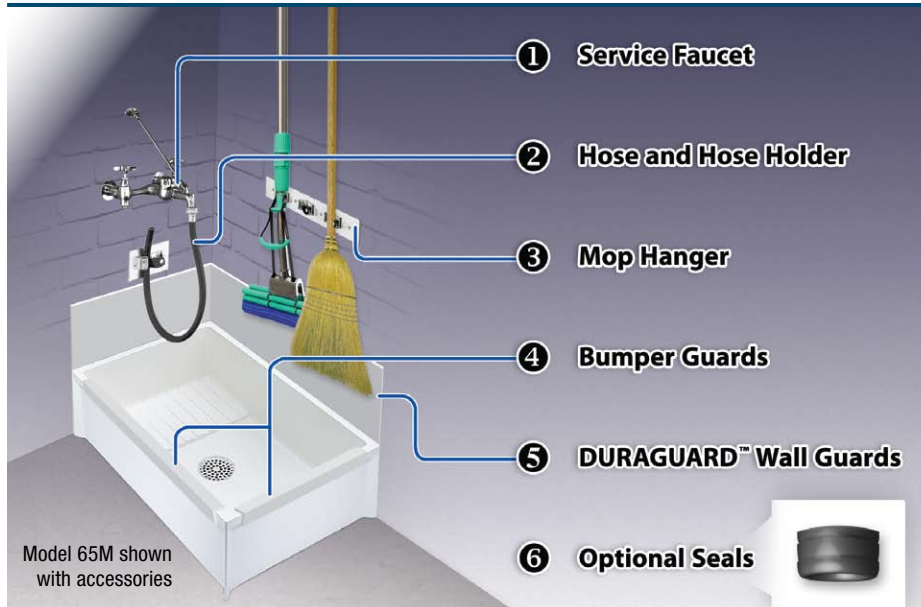

1 Service Faucet

Model 63.600A

Chrome plated brass service sink faucet, 1/2" pipe eccentric inlets on 8" centers. Vacuum breaker integral stops, chrome plated (H&C) handles, 3/4" hose end spout with pail hook, top reinforcing bar and mounting bracket. Shall meet ANSI Specifications A112.1.1, Section 2.9  and A112.18.1M, CSA Listed. 



2 Hose and Hose Holder

Model 65.700

Heavy duty 5/8" dia. reinforced 31" rubber hose with brass couplings on one end. Spring loaded, molded rubber hose holder mounts on stainless steel wall plate.



3 Mop Hanger

Model 65.600

Three spring-loaded rubber holders mounted to a 3" x 24" stainless steel wall plate.



4 Bumper Guards Available in high impact resistant molded vinyl (3 versions) or stainless steel (2 versions).

Model

High Impact-Resistant Vinyl

62.401 21 1/2" Long, Fits Model 62M

63.401 20 3/4" Long, Fits Model 63M & 65M

65.403 32 3/4" Long, Fits Model 65M

Model

Stainless Steel

63.403 20 3/4" Long, Fits Model 63M & 65M

65.404 32 3/4" Long, Fits Model 65M

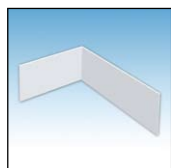

5 DURAGUARD™ Wall Guards

Model

67.2424 Two panels & bracket for 24" x 24" corner

67.24C One panel & corner bracket

Model

67.24C One 24" panel & corner bracket

67.36C One 36" panel & corner bracket

Protects wall surfaces from splashing and damage from impacts, 12" height, 20 gauge #304 stainless steel.

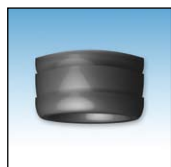

6 Optional Seals For installations with the following pipe connections:

Model

65.308 For 2" PVC, ABS and iron

65.309 For 3" PVC, ABS and iron, (Included w/mop basin)

Model

65.311 For 3" soil pipe (No-Hub)